

To Change Lever Handing

⚠ CAUTION ⚠

Do not remove springs from slider.

⚠ NOTE ⚠

Lever cannot be broken down unless trim is mounted on door and device is locked.

1 Remove four mounting studs.

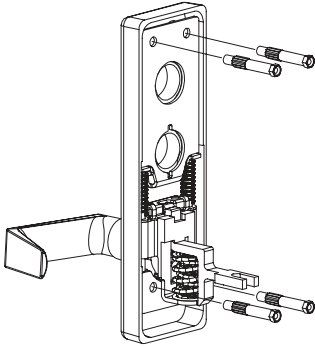

2 Remove endplate from under slider.

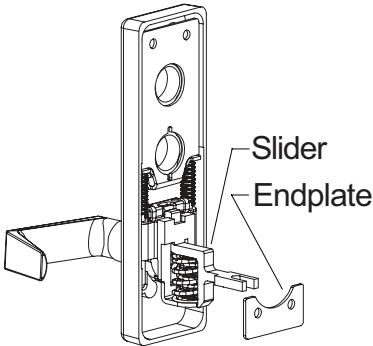

3 Push up on slider and pivot out to remove guide post assembly.

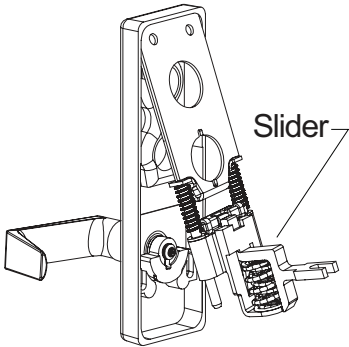

⚠ CAUTION ⚠

In Step 3, make sure to keep loose components on guide post assembly.

4 Use retaining pliers to remove retaining ring. Remove cam.

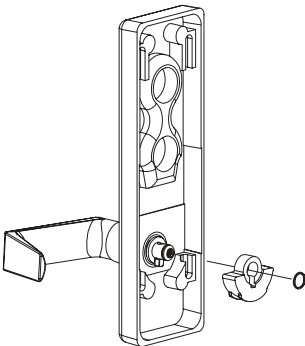

5 Use 3/32" hex wrench to loosen set screw. Remove shear pin.

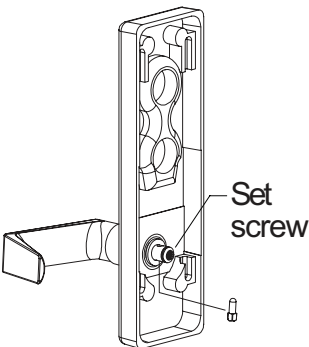

6 Remove spacer.

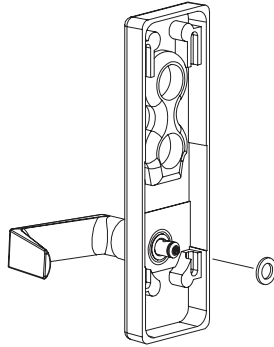

7 Place lever in RHR or LHR position.

RHR

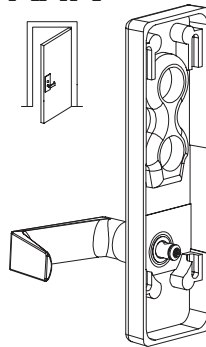
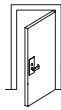

LHR

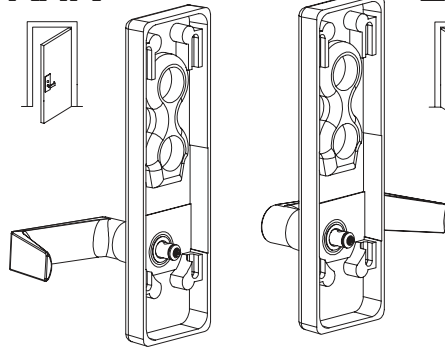
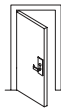

8 Re-install spacer (see Step 6).

9 Re-install shear pin with head pointed down (see Step 5).

10 Pull lever outwards to align shear pin head with spacer.

11 Re-install cam with "L" visible for LHR or "R" visible for RHR (see Step 4), then tighten set screw (see Step 5).

RHR

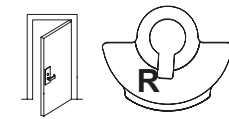

LHR



12 Re-install retaining ring (see Step 4).

13 Make sure lever is in horizontal position, then re-install guide post assembly.

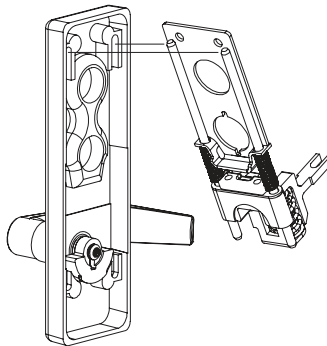

Tilt guide post assembly and insert tops of rods into slots

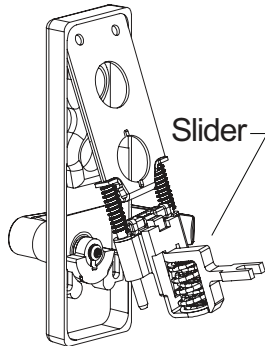

Push up on slider and pivot assembly in

14 Re-install end plate (see Step 2) and four mounting studs (see Step 1).

ⓘ Do not over-tighten studs.

Customer Service

1-877-671-7011

www.allegion.com



© Allegion 2014
Printed in U.S.A.
921003-00 Rev. 01/14-c