

# 19-V Series non-handed vertical rod device

## Panic exit hardware

Manufactured to the same standards as the 19 Rim, the 19-V exit device complies with most exit door requirements, and is fully reversible and surface applied. This device is regularly furnished with deadlocking top latch with latch retention and square bolt at bottom. The "EO" (exit only) device is ready to accept any trim function shown on page 12.

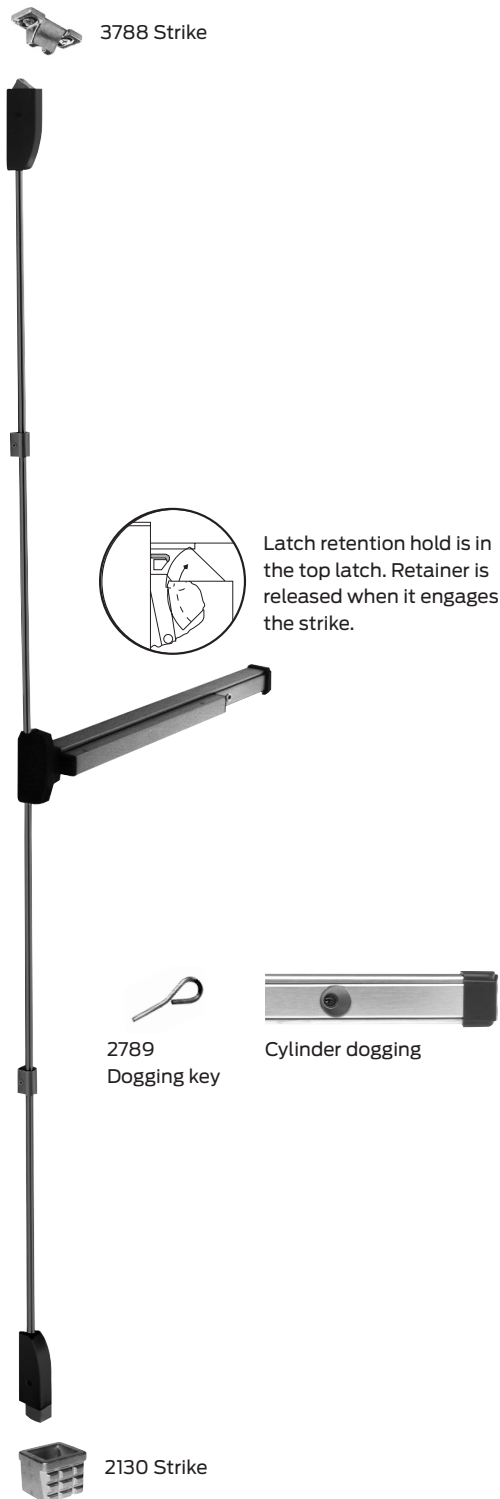

Device & trim	ANSI type	ANSI function
19-V-EO	2 or 5	01
19-V-DT	2 or 5	02
19-V-NL	2 or 5	03
19-V-K (or L)	2 or 5	08
19-V-K-NL (or KIL)	2 or 5	09

Note: For blank escutcheon specify BE.

### Specifications

Hand:	Field reversible.
Functions:	All functions built into "EO" device. All 19 Series trim works with rim or vertical devices. See Trim Selection Chart on pages 15 and 16.
Finishes:	Powder-coated aluminum-SP28; powder-coated duranodic-SP313; stainless steel US-32D.
Strikes:	3788 strike is surface applied standard, 2130 strike is mortised into floor.
Angle bracket:	Use 4215 angle bracket in flush transom or rabbeted installations. Allows use of standard 3788 strike.
Latchbolt:	Top stainless steel $\frac{3}{4}$ " throw. Bottom square bolt $\frac{1}{2}$ " throw.
Deadlocking latchbolt:	Standard.
Dogging feature:	Half turn hex dogging standard. No threaded parts to wear out.
Cylinder dogging:	Specify "CD" prefix. Use $1\frac{1}{8}$ " long mortise cylinder with standard "A" cam.
Stock sizes:	3' for doors from 2'5" up to 3'. 4' for doors from 3' up to 4'.
Doors:	$1\frac{3}{4}$ " thick, wood or metal. Specify thickness if other than $1\frac{3}{4}$ ".
Narrow stile doors:	To $1\frac{3}{4}$ " N.S. aluminum. With control trim- $2\frac{1}{4}$ " min. stile.
Projection:	$2\frac{1}{2}$ " max., $1\frac{7}{8}$ " dogged.
Fasteners:	All mounting screws are concealed. Furnished with sheet metal screws. Machine screws available, specify AMS.
Sex bolts:	3-#4122 ( $\frac{1}{4}$ "-20) SNB standard. Hollow core wood, light gauge hollow metal, etc. require additional sex bolts. 19-V: 6-#2729 #10-24 SNB; 19-V-LBR: 3-#2729 #10-24 SNB
ANSI:	Certified ANSI A156.3 2001 grade 1 standards.
19-V:	Latch retention and 3788 strike top, deadbolt and 2130 flush strike bottom.
19-V-LBR:	3788 strike top.
Vertical rods:	Furnished to length based on $40\frac{5}{16}$ " horizontal CL from finished floor and a 7'0" door standard. Variations from these standards must be specified when ordering.
Shim kit:	For glass lites applications; $\frac{1}{4}$ " thick specify SK-19-V- $\frac{1}{4}$ ".
161 cutout:	Device covers 161 cutout with KIK/KIL and Centron trims. Other trim requires cover plate.

# Trim designs

## Control trim

SP28, SP313 and US-32D.

### K-control



**911K**  
BE  
NL

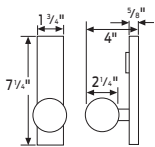

Key locks or unlocks trim. Knob retracts latchbolt when trim is unlocked.

### L-control



**L-Control-Dane**  
**912L**  
BE  
L-DT  
NL

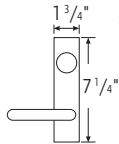

Lever Projection: Quantum = 3"  
Sutro = 2 7/8"  
Dane = 2 7/8"



**L-Control-Sutro**  
**912L**  
BE  
L-DT  
NL



**L-Control-Quantum**  
**912L**  
BE  
L-DT  
NL

Key locks or unlocks trim. Lever retracts latchbolt when trim is unlocked. Dane, Quantum and Sutro levers return to within 1/2" of door.

### DT-control



**918 DT**  
Pull when dogged.

### NL-control



**918NL**  
Key retracts latchbolt.

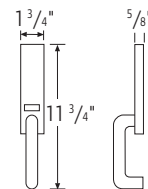

### Pull



**9970**  
Can be used with all devices (not for use on wood doors).

9 1/4" center to center

2 7/8" projection

1 3/4" clearance

## Cover plates



**4167**  
3 1/4" x 15" x .050  
Used with TP control & DT control  
Covers 161 & 86 cutouts



**4168**  
3 1/4" x 7 1/2" x .050  
Used with EO device to cover No. 86 cutout for mortise lock



**4170**  
3 1/4" x 7 1/2" x .050  
Used with K control, DT/K control, L control, or DT/L control  
Covers 161 & 86 cutouts

## Key-in-lever



**914KIL**



**914-KIL-IC**

For 1-3/4" thick doors only

## Centron trim

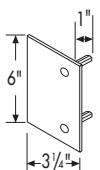

**930 EO**

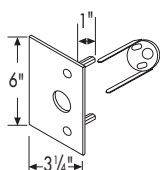

**930 C**

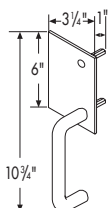

**930 DT**

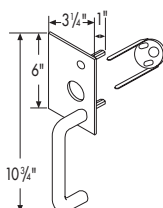

**930 NL**



**Pull only 917 DT**  
CTC - 5 1/2" round - 3/4" dia.  
Pull when dogged.

## Trident trim

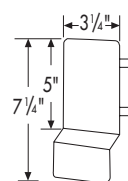

**920 DT**

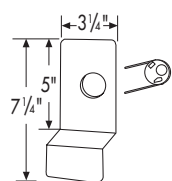

**920 NL**

# Trim chart

## Control

Device	DT	NL	T-BE	K	K-BE	K-DT
19-R/19-V	918	918	910	911	911	911
Cylinder type	—	rim	—	1 1/8" Mortise	—	—

Device	Dane*						Sutro*			Quantum*		
	L	L-BE	L-DT	L	L-BE	L-DT	L	L-BE	L-DT	L	L-BE	L-DT
19-R/19-V	912	912	912	912	912	912	912	912	912	912	912	912
Cylinder type	1 1/8" Mortise	—	—	1 1/8" Mortise	—	—	1 1/8" Mortise	—	—	1 1/8" Mortise	—	—

## KIL

Device	KIL*	KIL-LS/LK'	KIL-NL*	KIL-IC*
19-R/19-V	914	914	914	914
	Falcon "C" keyway A23160	—	Falcon "C" keyway A23160	Small format

## Trident trim

Device	Centron				
	NL	DT	C	DT	NL
19-R/19-V	920	920	930	930	930
Cylinder type	Rim	—	Rim	—	Rim

\* Specify hand.

Note: For "NL" night latch function on K and L add "NL" after trim number.  
All locking trim except KIL furnished less cylinder.

# Type and functions

These pages list all functions available for the 19 Series devices.

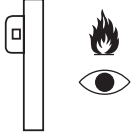
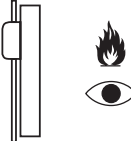
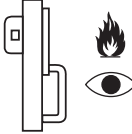
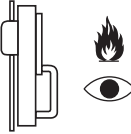
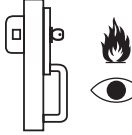
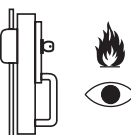
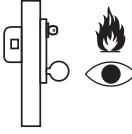
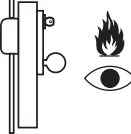
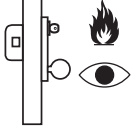
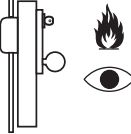
	Rim devices ANSI type 1 and 4.	Vertical rod devices ANSI type 2 and 5.
Functions (ANSI)	(F)-19-R	(F)-19-V
<b>EO or N (01)</b> Exit only, no trim.	 <b>19-R-EO</b>	 <b>19-V-EO</b>
<b>DT (02)</b> Entrance by trim when actuating bar is dogged down.*	 <b>19-R-DT</b>	 <b>19-V-DT</b>
<b>NL (03)</b> Entrance by trim when latchbolt is retracted by key. Key removable only when locked.	 <b>19-R-NL</b>	 <b>19-V-NL</b>
<b>K or L or KIL (08)</b> Entrance by knob or lever. Key locks or unlocks knob.	 <b>19-R-K or L or KIK or KIL</b>	 <b>19-V-K or L or KIK or KIL</b>
<b>K(NL) or L(NL) (09) or KIL (NL)</b> Entrance by knob or lever only when released by key. Key removable only when locked.	 <b>19-R-K (NL) or L(NL) or KIK(NL) or KIL(NL)</b>	 <b>19-V-K (NL) or L(NL) or KIK(NL) or KIL(NL)</b>



Fire exit hardware

Use "F" prefix for fire exit hardware.



Security monitor



Electric function

\*Latch, device, and authorize degress monitors. (See electrified hardware catalog.)

\*Fire exit devices cannot be dogged down. Some codes permit electric dogging with fail secure circuitry.

# Type and functions

## Double doors

Device & trim	Length	Top strike	Bottom strike	Min. stile	Door opening width
(F) 19-V	3'0"	3788	2130	3 1/2"	2' 5 1/4" to 3'0"
(F) 19-V	4'0"	3788	2130	3 1/2"	3'0" to 4'0"

Note: For (F-) 19-V-LBR use "V" information less bottom strike. F-19-V-LBR requires use of auxiliary fire latch.

## Single doors with 5/8" stop

Device & trim	Length	Strike	Min. stile	Door opening width
19-R	3'0"	F570	3 1/2"	2'5 1/4" to 3'0"
		565	1 3/4"*	2' 4 3/4" to 2' 9 1/4"
F-19-R	3'0"	F570	3 1/2"	2'5 1/4" to 3'0"
19-R	4'0"	F570	3 1/4"	3'0" to 4'0"
		565	1 3/4"*	3'0" to 3'9 3/4"
F-19-R	4'0"	F570	3 1/4"	3'0" to 4'0"

\*For EO and NL functions only. 2- 1/4" minimum stile required for control trim.

## Dimensions:

- Recommended height from finished floor - 40 5/16" at CL.
- Touchbar projections: neutral - 2 1/2" depressed - 1 7/8"
- Extension rods or longer top rods available upon request.
- Specify door height.
- Dummy touchbar available. Specify 190 DT 3' or 4'.
- Overall length: 3' 30 1/2"- 4' 42 5/8"
- Changes for minimum door size for charts on left:
- For cylinder dogging, add 2 1/4" to minimum door size.
- For exit alarm, add 4 1/2" to minimum door size.
- To fit on smaller door consult factory

## Double doors with Mullion

Device & trim	Length	Strike	Min. stile	Door opening width	Fire	Panic
19-R	3'0"	F570	3 1/2"	2'5 1/4" to 3'0"	—	29231
			3 3/4"		—	4023/ KR4-23
		565	3 1/8"	2'4 3/4" to 2'9 1/4"	—	29231
			3 3/8"		—	4023/KR4023
F-19-R	3'0"	F-570	3 3/4"	2'5 1/4" to 3'0"	(F)4023	—
					KR(F)4023	—
19-R	4'0"	F570	3 1/2"	3'0" to 4'0"	—	29231
			3 3/4"		—	4023/ KR4-23
		565	3 1/8"	3'0" to 3'9 3/4"	—	29231
			3 3/8"		—	4023/KR4023
F-19-R	4'0"	F-570	3 3/4"	3'0" to 4'0"	(F)4023	—
					KR(F)4023	—

<sup>1</sup> To cover 161 cutout on double door installation, specify 2923 mullion with 565 strike.



# Door applications

## Door thickness

All devices and components supplied for 1 3/4" doors standard. Specify door thickness if other than 1 3/4".

Number	BHMA/ANSI function
01	Exit only, no trim.
02	Entrance by trim when actuating bar is locked down.
03	Entrance by trim when latchbolt is retracted by key; key removable only when locked.
04	Entrance by trim when latchbolt is retracted by key or set in a retracted position by key.
08	Entrance by knob or lever; key locks or unlocks knob or lever.
09	Entrance by knob or lever only when released by keys; key removable only when locked.

U.S. standard	BHMA	Description
US28	628	Anodized aluminum – clear
DC13	710	Anodized aluminium – dark bronze
DC35	711	Anodized aluminum – black
P28	689	Painted aluminum – silver
P13	695	Painted aluminum – dark bronze
P35	622	Painted aluminum – black
US3	666	Bright brass
US4	667	Satin brass
US9	705	Bright bronze
US10	668	Satin bronze
US10B	703	Oxidized satin bronze
US14	669	Bright nickel
US15	670	Satin nickel
US26	672	Bright chrome
US26D	702	Satin chrome

## Door application chart

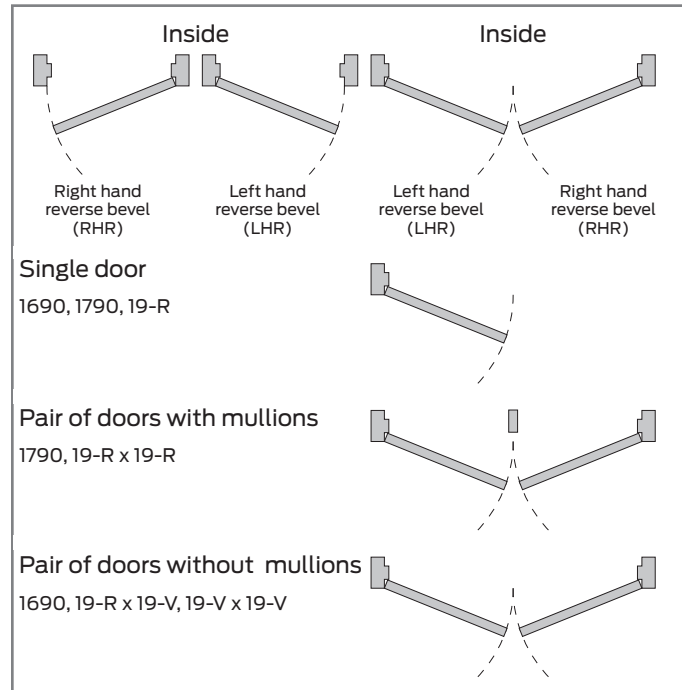

Device	Label	Door opening	Application
<b>Hollow metal door</b>			
F-19-R	1 1/2 hr. "B"	4' x 7'2" 8' x 7'2"	Single, pair, same egress w/ F-4023 mullion and KR-F-4023
F-19-V	1 1/2 hr. "B"	8' x 10'	Pair, double egress, same egress
F-19-V-LBR	1 1/2 hr. "B"	8' x 8'	Pair, double egress, same egress
<b>Wood door</b>			
F-19-V-LBR	20 min.	8' x 8'	Wood or comp., pair, double egress, same egress
F-19-R	1 1/2 hr. "B"	4' x 7'2" 8' x 7'2"	Single, pair, same egress w/ F-4023 mullion and KR-F-4023

## 19 Device dimensions:

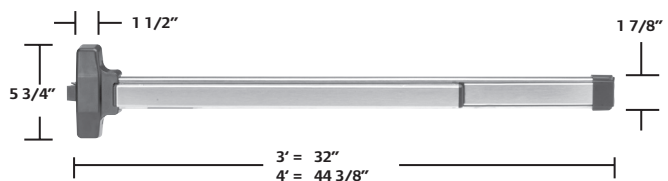

# Strikes

## 1690 Concealed vertical rod device



### PB48

Top strike for 1690 device. Packed with three 0.050" thick shims. 1 1/16" x 1 1/16" x 7/16" (H x W x D)

## 1790 Rim device



### STK45

Strike for inactive leaf, pair of doors with 1790 device. 3 1/4" x 1 5/16" x 1/4" (H x W x D)



### TD35

Strike for single doors, 1790 device. Includes 1/8" shim. 3" x 2" x 1/2" (H x W x D)

## (F) 19-R Rim devices



### F570

Standard strike. 2 5/8" x 1 1/4" x 13/16" (H x W x D)



### F490

Optional strike. 2 5/8" x 1 1/4" x 7/8" (H x W x D)



### 565

Adjustable surface mounted for use with blade or applied stops. Mounts flush for 1/2" stop height.



### 571/571A

Used on inactive leaf for device on active leaf of pair of doors without removable mullion. 571 keeps 2 5/16" backset. 571A is trimmer and projects less into opening.

## (F) 19-V Surface vertical rod devices



### 3788

Top strike for 19-V.



### 2130

19-V bottom strike for grouting into concrete or masonry floors.



### 4155

19-V optional bottom strike.



### 2126A

19-V optional bottom strike.

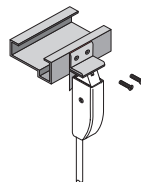

### 4215

Angle bracket for 19-V devices flush transom applications. Does not require elimination of latch retention feature.



### Extension rods

Extension rods are available in 12", 24" and 36" lengths in all finishes. Both ends tapped and all-thread included as connector.

# Accessories

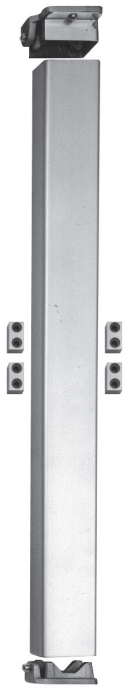

F-4023 Shown

## Removable mullion

- Removable mullions are easily removed and reinstalled for full width access
- Increased security and tighter closure
- Minimizes door warp age and sag
- Regulates the traffic flow in-and-out
- Rim devices are used on both leaves, attaining a perfect symmetrical opening
- Mullion assembly consists of a mullion, top and bottom fittings and mounting package
- Mullion can be cut on the job for doors under stock lengths

## 2923, (F)4023, (F)KR4023 Mullion

These steel mullions can be used with the 19-R and F-19-R devices. Soffit adapters are available for the 2923 and 4023 mullions. The F4023 and F-KR4023 fire-rated mullions also include four stabilizer blocks as required for labeled installations. Strikes are not included with mullion and should be specified with the 19-R or F-19-R device, see page 11 for strike information. KR mullions require 1 1/4" mortise cylinder with standard "A" cam. The mullion fittings are made from ductile iron. The (F)4023 and (F)KR4023 are 2" wide and 3" deep. The 2923 is 1 1/2" wide and 2 1/2" deep. Furnished in prime coat.

## Mullions



RM 170

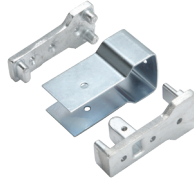

Mullion brackets



525 Mullion stabilizer for RM170

## RM 170 Removable mullion

RM 170 for use with 1790 series. Comes complete with adjustable mortised strikes and security clips. Compatible with doors 7' to 10' and for use with stiles as narrow as 1 3/4". Made of aluminum, available in anodized aluminum or bronze finishes. Mullion is 3 1/2" deep, 1" wide on door side, and 1 5/8" at the widest point.

## Mullion strikes



### STK170

Adjustable mortise strikes (pair).

2 7/8" tall  
1 3/4" wide  
1" thick

## Sex bolts

Sex bolts are available for 1 3/4" door thickness. Screws to fit are available in 3/4" and 2" lengths to cover a wide range of door thicknesses.  
2729 (#10-24 thread)  
4122 (1/4"-20 thread)

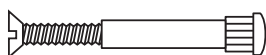

## Filler plates

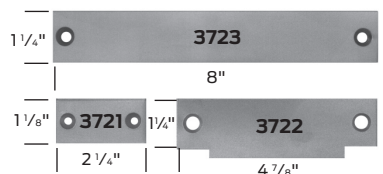

### 3721/3722/3723

Steel filler plates

- 3721 Cylindrical lock frontfiller
- 3722 ASA strike filler - set no. SC for 161 cutout
- 3723 Mortise lock front filler
- 3722 ASA strike filler - set no. SM for 86 cutout



# 19 Series

		F	19	V	L-DANE	US32D	3'	L	HR	LBR	SNB	WD
<b>Prefixes</b>												
CD	Cylinder dogging											
KOR	Key bypass switch											
<b>Rating</b>												
F	Fire exit hardware											
Blank	Panic exit hardware											
<b>Device Series</b>												
19	Touch bar device, narrow stile											
<b>Device Type</b>												
R	Rim											
V	Surface vertical rod											
<b>Trim Function</b> (see Trim pages for all functions)												
EO	Exit only											
DT	Dummy trim											
NL	Night latch											
C	Cylinder trim less pull											
K	Knob											
L	Lever (dane standard)											
TL	Thumb lever											
KIL	Key in lever											
<b>Finish</b>												
US32D												
SP28												
SP313												
<b>Door Width</b>												
3'	Standard default											
4'												
—	Specify exact door width											
<b>Handing</b>												
RHR	Right hand reverse											
LHR	Left hand reverse											
<b>Less bottom rod</b>												
LBR	Less bottom rod											
LBR-AFL	LBR w/auxiliary fire latch											
<b>Other device options</b>												
RBB	Round bottom bolt											
SSTB	Stainless steel touch bar											
VRP	Black pad on touch bar											
TAC	Tactile warning											
<b>Accessories</b>												
CYL	Cylinder											
SNB	Sex bolts											
SK	Shim kit											
AMS	All machine screws											
<b>Other miscellaneous door information</b>												
HMD	Hollow metal door											
HMF	Hollow metal frame											
WD	Wood door											
WDF	Wood frame											
ALD	Aluminum door											
ALF	Aluminum frame											
SCDC	Steel channel door construction											
—	Specify other door or frame											
—	Material information											
—	Door height											
—	Door thickness											
—	Door undercut											
—	Door label (20 min, 45 min, 90 min 1-1/2 hr)											
—	Stile width											
—	Frame stop height											
SGL	Single door											
PR	Pair of doors swinging same direction											