

19-R Series non-handed rim device

Panic exit hardware

The Falcon 19-R Series rim device that delivers superior panic hardware with modern touchbar styling.

This non-handed device covers a 161 cutout and may be used on 1 3/4" narrow stile aluminum doors.

The "EO" (exit only) device is ready to accept any trim function shown on page 12.

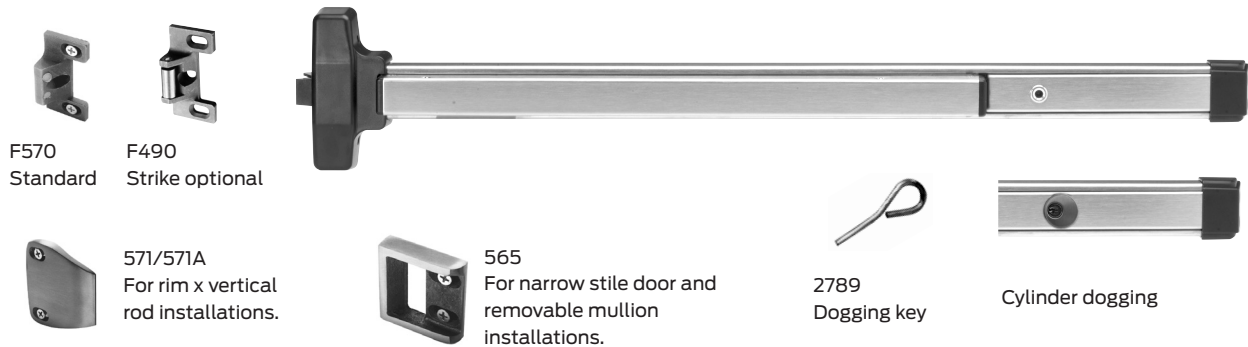

Device & trim	ANSI type	ANSI function
19-R-EO	1 or 4	01
19-R-DT	1 or 4	02
19-R-NL	1 or 4	03
19-R-K (or L or KIL)	1 or 4	08
19-R-K-NL (or L-NL or kil-nl)	1 or 4	09
19-R-TP-BE	1 or 4	
19-R-K-BE	1 or 4	
19-R-K-DT	1 or 4	
19-R-L-BE	1 or 4	
19-R-L-DT	1 or 4	
19-R-KIL-BE	1 or 4	
19-R-KIL-DT	1 or 4	

Note: For blank escutcheon specify BE.

Specifications

Hand:	Non-handed.
Functions:	See trim selection chart on this page.
Finishes:	SP28, SP313, US32D. Centercase and end cap are powder-coated black only.
Strikes:	Standard - F570. Optional - F490, 565, 571, 571A.
Latch:	Stainless steel, 3/4" throw dead locking.
Dogging feature:	Hex key dogging standard. Cylinder dogging or less dogging optional.
Sizes:	3' for doors from 2'5" up to 3'. 4' for doors from 3' up to 4'.
Doors:	1 3/4" thick metal or wood doors, specify if other.
Projections:	2 1/2" in neutral position, 1 7/8" in dogged position. Pushbar height is 1 3/4".
Stile:	1 3/4" minimum.
Fasteners:	All machine screw mounting. Device mounting fasteners are concealed, latch fasteners are exposed to egress side.
End caps:	Black plastic end caps.
ANSI:	Certified ANSI A156.3 grade 1 standards.

Trim designs

Control trim

SP28, SP313 and US-32D.

K-control



911K
BE
NL

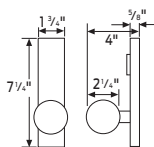

Key locks or unlocks trim. Knob retracts latchbolt when trim is unlocked.

L-control



L-Control-Dane
912L
BE
L-DT
NL

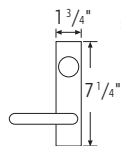

Lever Projection: Quantum = 3"
Sutro = 2 7/8"
Dane = 2 7/8"



L-Control-Sutro
912L
BE
L-DT
NL



L-Control-Quantum
912L
BE
L-DT
NL

Key locks or unlocks trim. Lever retracts latchbolt when trim is unlocked. Dane, Quantum and Sutro levers return to within 1/2" of door.

DT-control



918 DT
Pull when dogged.

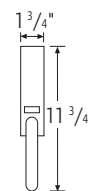

NL-control



918NL
Key retracts latchbolt.



Pull



9970
Can be used with all devices (not for use on wood doors).

9 1/4" center to center
2 7/8" projection
1 3/4" clearance

Cover plates



4167
3 1/4" x 15" x .050
Used with TP control & DT control
Covers 161 & 86 cutouts



4168
3 1/4" x 7 1/2" x .050
Used with EO device to cover No. 86 cutout for mortise lock



4170
3 1/4" x 7 1/2" x .050
Used with K control, DT/K control, L control, or DT/L control
Covers 161 & 86 cutouts

Key-in-lever



914KIL



914-KIL-IC

For 1-3/4" thick doors only

Centron trim

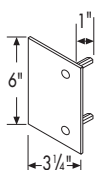

930 EO

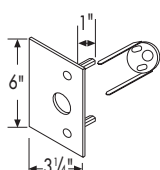

930 C

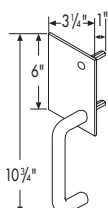

930 DT

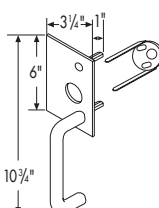

930 NL



Pull only 917 DT
CTC - 5 1/2" round - 3/4" dia.
Pull when dogged.

Trident trim

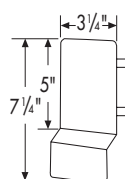

920 DT

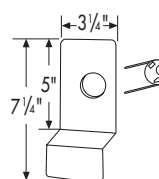

920 NL

Trim chart

Control

Device	DT	NL	T-BE	K	K-BE	K-DT
19-R/19-V	918	918	910	911	911	911
Cylinder type	—	rim	—	1 1/8" Mortise	—	—

Device	Dane*						Sutro*			Quantum*		
	L	L-BE	L-DT	L	L-BE	L-DT	L	L-BE	L-DT	L	L-BE	L-DT
19-R/19-V	912	912	912	912	912	912	912	912	912	912	912	912
Cylinder type	1 1/8" Mortise	—	—	1 1/8" Mortise	—	—	1 1/8" Mortise	—	—	1 1/8" Mortise	—	—

KIL

Device	KIL*	KIL-LS/LK'	KIL-NL*	KIL-IC*
19-R/19-V	914	914	914	914
	Falcon "C" keyway A23160	—	Falcon "C" keyway A23160	Small format

Trident trim

Device	Centron				
	NL	DT	C	DT	NL
19-R/19-V	920	920	930	930	930
Cylinder type	Rim	—	Rim	—	Rim

* Specify hand.

Note: For "NL" night latch function on K and L add "NL" after trim number.
All locking trim except KIL furnished less cylinder.

Type and functions

These pages list all functions available for the 19 Series devices.

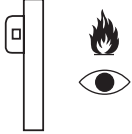
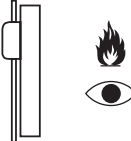
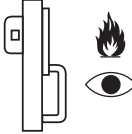
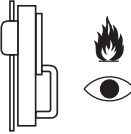
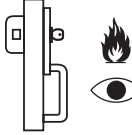
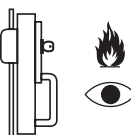
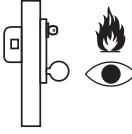
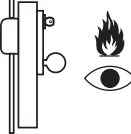
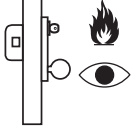
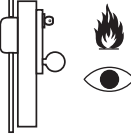
	Rim devices ANSI type 1 and 4.	Vertical rod devices ANSI type 2 and 5.
Functions (ANSI)	(F)-19-R	(F)-19-V
EO or N (01) Exit only, no trim.	 19-R-EO	 19-V-EO
DT (02) Entrance by trim when actuating bar is dogged down.*	 19-R-DT	 19-V-DT
NL (03) Entrance by trim when latchbolt is retracted by key. Key removable only when locked.	 19-R-NL	 19-V-NL
K or L or KIL (08) Entrance by knob or lever. Key locks or unlocks knob.	 19-R-K or L or KIK or KIL	 19-V-K or L or KIK or KIL
K(NL) or L(NL) (09) or KIL (NL) Entrance by knob or lever only when released by key. Key removable only when locked.	 19-R-K (NL) or L(NL) or KIK(NL) or KIL(NL)	 19-V-K (NL) or L(NL) or KIK(NL) or KIL(NL)



Fire exit hardware

Use "F" prefix for fire exit hardware.



Security monitor



Electric function

*Latch, device, and authorize degress monitors. (See electrified hardware catalog.)

*Fire exit devices cannot be dogged down. Some codes permit electric dogging with fail secure circuitry.

Type and functions

Double doors

Device & trim	Length	Top strike	Bottom strike	Min. stile	Door opening width
(F) 19-V	3'0"	3788	2130	3 1/2"	2' 5 1/4" to 3'0"
(F) 19-V	4'0"	3788	2130	3 1/2"	3'0" to 4'0"

Note: For (F-) 19-V-LBR use "V" information less bottom strike. F-19-V-LBR requires use of auxiliary fire latch.

Single doors with 5/8" stop

Device & trim	Length	Strike	Min. stile	Door opening width
19-R	3'0"	F570	3 1/2"	2'5 1/4" to 3'0"
		565	1 3/4"*	2' 4 3/4" to 2' 9 1/4"
F-19-R	3'0"	F570	3 1/2"	2'5 1/4" to 3'0"
19-R	4'0"	F570	3 1/4"	3'0" to 4'0"
		565	1 3/4"*	3'0" to 3'9 3/4"
F-19-R	4'0"	F570	3 1/4"	3'0" to 4'0"

*For EO and NL functions only. 2- 1/4" minimum stile required for control trim.

Dimensions:

- Recommended height from finished floor - 40 5/16" at CL.
- Touchbar projections: neutral - 2 1/2" depressed - 1 7/8"
- Extension rods or longer top rods available upon request.
- Specify door height.
- Dummy touchbar available. Specify 190 DT 3' or 4'.
- Overall length: 3' 30 1/2"- 4' 42 5/8"
- Changes for minimum door size for charts on left:
- For cylinder dogging, add 2 1/4" to minimum door size.
- For exit alarm, add 4 1/2" to minimum door size.
- To fit on smaller door consult factory

Double doors with Mullion

Device & trim	Length	Strike	Min. stile	Door opening width	Fire	Panic
19-R	3'0"	F570	3 1/2"	2'5 1/4" to 3'0"	—	29231
			3 3/4"		—	4023/ KR4-23
		565	3 1/8"	2'4 3/4" to 2'9 1/4"	—	29231
			3 3/8"		—	4023/KR4023
F-19-R	3'0"	F-570	3 3/4"	2'5 1/4" to 3'0"	(F)4023	—
					KR(F)4023	—
19-R	4'0"	F570	3 1/2"	3'0" to 4'0"	—	29231
			3 3/4"		—	4023/ KR4-23
		565	3 1/8"	3'0" to 3'9 3/4"	—	29231
			3 3/8"		—	4023/KR4023
F-19-R	4'0"	F-570	3 3/4"	3'0" to 4'0"	(F)4023	—
					KR(F)4023	—

¹ To cover 161 cutout on double door installation, specify 2923 mullion with 565 strike.



Door applications

Door thickness

All devices and components supplied for 1 3/4" doors standard. Specify door thickness if other than 1 3/4".

Number	BHMA/ANSI function
01	Exit only, no trim.
02	Entrance by trim when actuating bar is locked down.
03	Entrance by trim when latchbolt is retracted by key; key removable only when locked.
04	Entrance by trim when latchbolt is retracted by key or set in a retracted position by key.
08	Entrance by knob or lever; key locks or unlocks knob or lever.
09	Entrance by knob or lever only when released by keys; key removable only when locked.

U.S. standard	BHMA	Description
US28	628	Anodized aluminum – clear
DC13	710	Anodized aluminium – dark bronze
DC35	711	Anodized aluminum – black
P28	689	Painted aluminum – silver
P13	695	Painted aluminum – dark bronze
P35	622	Painted aluminum – black
US3	666	Bright brass
US4	667	Satin brass
US9	705	Bright bronze
US10	668	Satin bronze
US10B	703	Oxidized satin bronze
US14	669	Bright nickel
US15	670	Satin nickel
US26	672	Bright chrome
US26D	702	Satin chrome

Door application chart

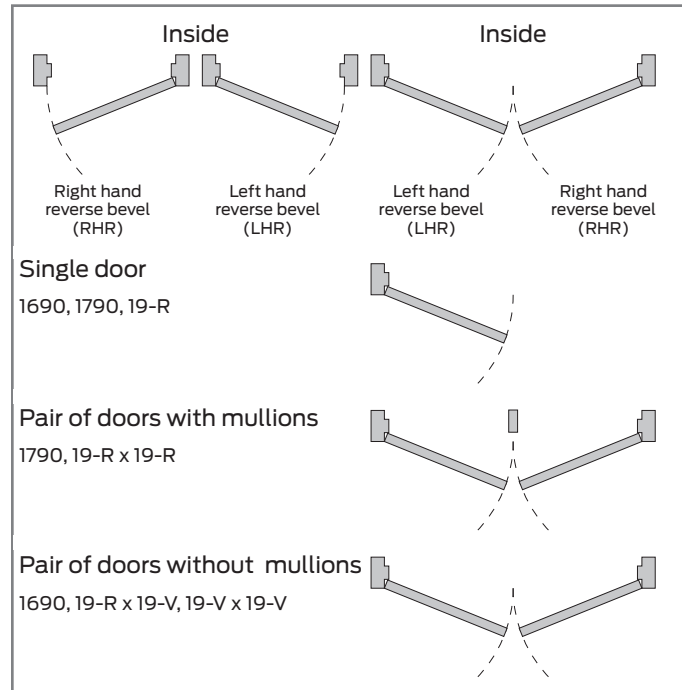

Device	Label	Door opening	Application
Hollow metal door			
F-19-R	1 1/2 hr. "B"	4' x 7'2" 8' x 7'2"	Single, pair, same egress w/ F-4023 mullion and KR-F-4023
F-19-V	1 1/2 hr. "B"	8' x 10'	Pair, double egress, same egress
F-19-V-LBR	1 1/2 hr. "B"	8' x 8'	Pair, double egress, same egress
Wood door			
F-19-V-LBR	20 min.	8' x 8'	Wood or comp., pair, double egress, same egress
F-19-R	1 1/2 hr. "B"	4' x 7'2" 8' x 7'2"	Single, pair, same egress w/ F-4023 mullion and KR-F-4023

19 Device dimensions:

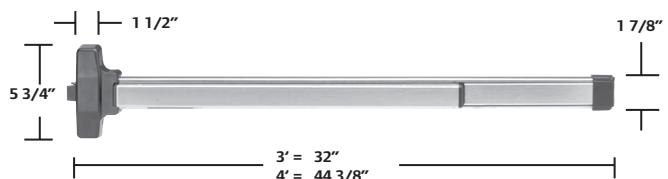

Strikes

1690 Concealed vertical rod device



PB48

Top strike for 1690 device. Packed with three 0.050" thick shims. 1 1/16" x 1 1/16" x 7/16" (H x W x D)

1790 Rim device



STK45

Strike for inactive leaf, pair of doors with 1790 device. 3 1/4" x 1 5/16" x 1/4" (H x W x D)



TD35

Strike for single doors, 1790 device. Includes 1/8" shim. 3" x 2" x 1/2" (H x W x D)

(F) 19-R Rim devices



F570

Standard strike. 2 5/8" x 1 1/4" x 13/16" (H x W x D)



F490

Optional strike. 2 5/8" x 1 1/4" x 7/8" (H x W x D)



565

Adjustable surface mounted for use with blade or applied stops. Mounts flush for 1/2" stop height.



571/571A

Used on inactive leaf for device on active leaf of pair of doors without removable mullion. 571 keeps 2 5/16" backset. 571A is trimmer and projects less into opening.

(F) 19-V Surface vertical rod devices



3788

Top strike for 19-V.



2130

19-V bottom strike for grouting into concrete or masonry floors.



4155

19-V optional bottom strike.



2126A

19-V optional bottom strike.

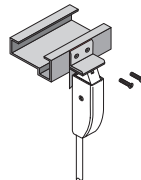

4215

Angle bracket for 19-V devices flush transom applications. Does not require elimination of latch retention feature.



Extension rods

Extension rods are available in 12", 24" and 36" lengths in all finishes. Both ends tapped and all-thread included as connector.

Accessories

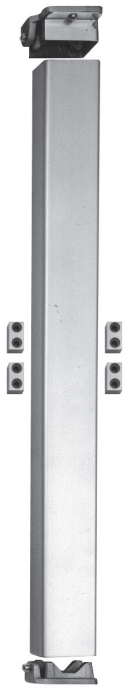

F-4023 Shown

Removable mullion

- Removable mullions are easily removed and reinstalled for full width access
- Increased security and tighter closure
- Minimizes door warp age and sag
- Regulates the traffic flow in-and-out
- Rim devices are used on both leaves, attaining a perfect symmetrical opening
- Mullion assembly consists of a mullion, top and bottom fittings and mounting package
- Mullion can be cut on the job for doors under stock lengths

2923, (F)4023, (F)KR4023 Mullion

These steel mullions can be used with the 19-R and F-19-R devices. Soffit adapters are available for the 2923 and 4023 mullions. The F4023 and F-KR4023 fire-rated mullions also include four stabilizer blocks as required for labeled installations. Strikes are not included with mullion and should be specified with the 19-R or F-19-R device, see page 11 for strike information. KR mullions require 1 1/4" mortise cylinder with standard "A" cam. The mullion fittings are made from ductile iron. The (F)4023 and (F)KR4023 are 2" wide and 3" deep. The 2923 is 1 1/2" wide and 2 1/2" deep. Furnished in prime coat.

Mullions



RM 170

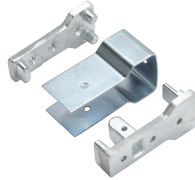

Mullion brackets



525 Mullion stabilizer for RM170

RM 170 Removable mullion

RM 170 for use with 1790 series. Comes complete with adjustable mortised strikes and security clips. Compatible with doors 7' to 10' and for use with stiles as narrow as 1 3/4". Made of aluminum, available in anodized aluminum or bronze finishes. Mullion is 3 1/2" deep, 1" wide on door side, and 1 5/8" at the widest point.

Mullion strikes



STK170

Adjustable mortise strikes (pair).

2 7/8" tall

1 3/4" wide

1" thick

Sex bolts

Sex bolts are available for 1 3/4" door thickness. Screws to fit are available in 3/4" and 2" lengths to cover a wide range of door thicknesses.

2729 (#10-24 thread)

4122 (1/4"-20 thread)

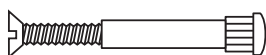

Filler plates

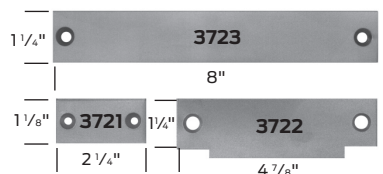

3721/3722/3723

Steel filler plates

3721 Cylindrical lock frontfiller

3722 ASA strike filler - set no. SC for 161 cutout

3723 Mortise lock front filler

3722 ASA strike filler - set no. SM for 86 cutout

19 Series

[illegible]